

N
9

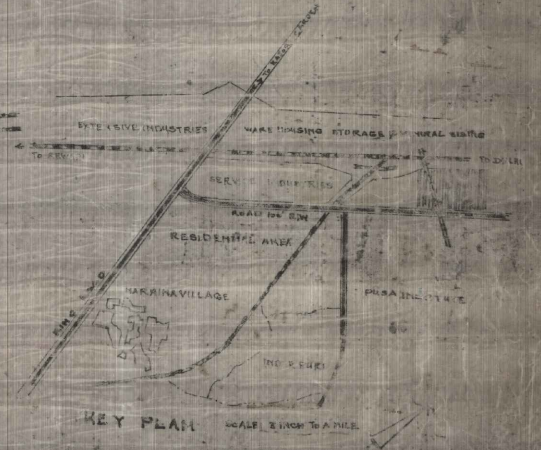
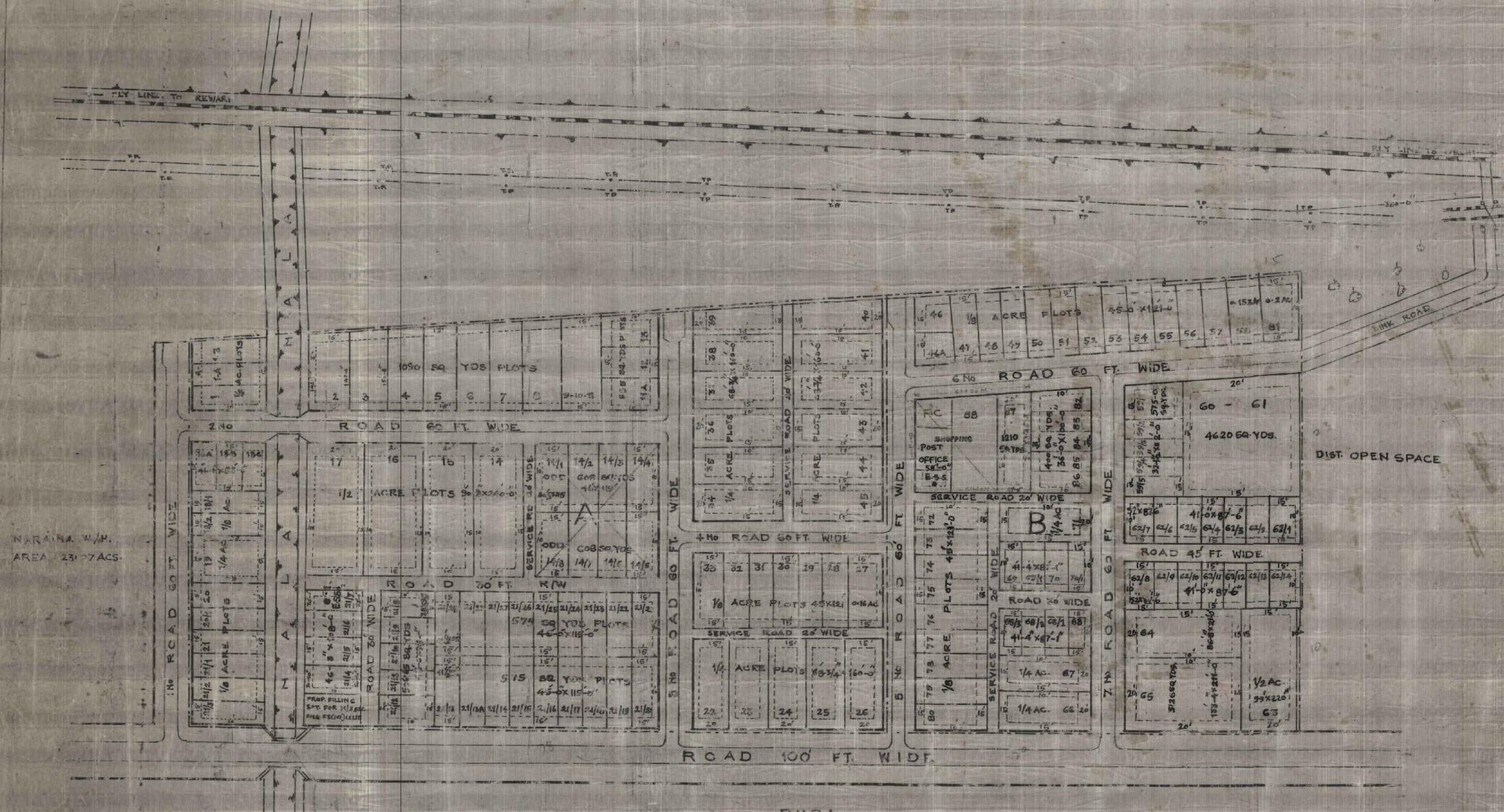

NARAINA W/M.
AREA 23.77 ACS.

STATEMENT OF PLOTS

400 SQ YDS. PLOTS	= 36 No.
1/8 ACRE PLOTS	= 7 No.
1/4 ACRE PLOTS	= 3 No.
1/2 ACRE PLOTS	= 1 No.
ODD PLOTS ABOVE 1/4 AC.	= 2 No.
ODD " BELOW 1/4 "	= 2 No.
TOTAL Nos. OF PLOTS	= 51 Nos.

AREA STATEMENT

TOTAL AREA OF THE SCHEME	= 23.77 ACS
AREA UNDER PLOTS	= 23.33 ACS
AREA UNDER ROADS	= 0.44 ACS
AREA UNDER FACILITIES	= 0.00 ACS

- NOTE**
- AS PER V.C.'S ORDER 554 HAS BEEN 35710 HAVING PLOT NO 21/7 AND PLOT 21/4 1021, MARKED 103 M-0 514.43 SQ YDS EACH IN BLOCK-A FILE NO F-1(37)78 L.S.B(1)
 - MODIFIED AS PER U.G. GOVERNOR ORDER DATED 16/6/71 IN FILE NO F-1(37)61 W.D. (P.C. JAIN)
 - PLOT NO 60, 61 & 62/1 IN BLOCK-A HAS BEEN MARKED AS PER E.M.'S ORDER 22-72 IN FILE NO F-2(106)621480
 - ADDITIONAL PLOTS NO 2/15 & 2/127 REMAINED 0.17 AND DEMARCATION CORRECTED AS PER V.C.'S ORDER DATED 10/12/75 IN FILE NO F-6(107)75 L.S.B(1)
 - 500 SQ YDS. PLOT PROPOSED FOR P.S.T. DEPTT. POST OFFICE INFACULTY CENTRE ADMINING E.S.S. FILE NO F-2(37)71 L.S.B(1) (V.V. BODAS)
 - SUB DIVISION OF PLOT NO 18 IN BLOCK-A INTO THREE EQUAL PLOTS OF 385-48 SQ YDS. EACH AS APPROVED BY E.M. IN FILE NO. F-6(36)76 L.S.B(1)
 - LINK ROAD SHOWN AS PER V.C.'S ORDER DT. 1/1/77 REF. NO. E.M. 1/67
 - AREA OF PLOT NO. 67 HAVE 12,000 SQ YDS. AS PER V.C. ORDER FILE NO. F-10(184)70 L.S.B(1)

NARAINA INDUSTRIAL AREA PHASE II

LAY OUT PLAN

SCALE: 1" = 100'	DATE: 19/9/80	CHECKED: [Signature]
DESIGNED BY: [Signature]	DATE: 19/9/80	CHECKED: [Signature]
APPROVED BY: [Signature]	DATE: 19/9/80	CHECKED: [Signature]

Verified
19/9/80